

快速鑽夾頭

TYPE:150

KEYLESS DRILL CHUCK

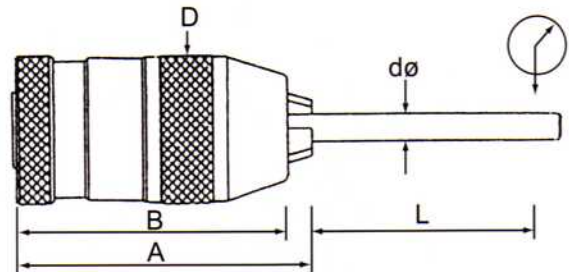

特性:

- (1) 自動地增加其抓著力及扭距, 以避免工具鬆脫。
- (2) 僅需要用手鎖緊, 不需要"key"。
- (3) 所有零件都經過內、外精密研磨處理。
- (4) 應用於重負荷和一般傳統設備等使用之。
- (5) 偏轉量和轉矩檢驗表:(A)

Characteristics:

- (1) Automatically increase its clamping force and torque to avoid loosening of the tool.
- (2) Only need to screw firmly with hand, and needless of "key"
- (3) All parts are treated under interior and exterior grinding process.
- (4) Applicable to heavy-duty load and traditional general equipment, etc.
- (5) Run-out Accuracy & Torque Inspection Table: (A)

■ 偏轉量和轉矩檢驗表:(A)

單位:m/m

產品型號 MODEL No.	1/4"		3/8"		1/2"		5/8"	
圓棒直徑 Ød	8	3 6 10	5 10 13	5 10 16				
圓棒長度 L	50	35 58	55 75	55 80				
最大偏轉量 Max Run-out	0.05	0.05	0.05	0.05				
轉矩(kgf-cm) Torque	80	130	200	300				

單位:m/m

產品編號 STYLE No.	產品規格 MODEL No.	內孔斜度 DIN or JACOBS	夾持範圍 Clamping Capacity (mm / inch)	直徑 D	長度		淨重 Wt (kgs)
					開 B	閉 A	
150-02010-0800	1/4"	J1	0-8.0 0-5/16"	34	61	69	0.340
150-02100-0800	1/4"	B10		34	61	69	0.340
150-02120-0800	1/4"	B12		34	61	69	0.340
150-03020-1000	3/8"	J2	0-10.0 0-3/8"	43	81	92	0.700
150-03330-1000	3/8"	J33		43	81	92	0.700
150-03120-1000	3/8"	B12		43	81	92	0.705
150-03160-1000	3/8"	B16		43	81	92	0.705
150-04020-1300	1/2"	J2	0-13.0 0-1/2"	51.5	92	103	1.030
150-04060-1300	1/2"	J6		51.5	92	103	1.030
150-04330-1300	1/2"	J33		51.5	92	103	1.035
150-04160-1300	1/2"	B16		51.5	92	103	1.030
150-05030-1630	5/8"	J3	3.0-16.0 1/8"-5/8"	58	95	108	1.370
150-05060-1630	5/8"	J6		58	95	108	1.370
150-05120-1630	5/8"	B12		58	95	108	1.365
150-05160-1630	5/8"	B16		58	95	108	1.340